



S U P E R C E N T R E

Leasing Brochure

Centre Information:

Q Super Centre is a sub-regional community based convenience centre prominently located in Mermaid Waters on the Gold Coast. The centre's location is bounded by two major arterial roads being Bermuda Street running north-south and Markeri Street, running east-west.

Q Super Centre offers a unique retail combination. A convenient single level shopping centre with three supermarkets complementing an alfresco dining precinct and selection of speciality stores.

The relaxed open-air mall design and point of difference with a dog friendly policy is very conducive to the Gold Coast climate and our customers' lifestyle. Trading seven days a week, the centre has a very strong mix of retailers including Woolworths, Coles and ALDI Supermarkets, Bunnings Warehouse, Choice Variety Store and Petbarn. Other leading national tenants include Australia Post, Chempro Chemist, McDonald's, Subway, Aussie Home Loans, Bank of Queensland, Bendigo Bank, Commonwealth Bank and Heritage Building Society.

Trade Area Profile:

Gold Coast's population is more than 620,000. It is Australia's 6th largest city, and larger than two other Australian capitals. Q Super Centre's primary trade area draws shoppers predominantly from a 6km radius in and around the Mermaid Waters, Robina, Miami, Clear Island Waters and Broadbeach Waters areas. The trade area comprises a population of approximately 80,000 residents with a median age of 40. With the Sunland Lakes/Lanes 1400 residence master planned community development underway on our northern border, Q Super Centre is excited to be welcoming many more residents to those numbers in the coming years.

Core Trading Hours

Monday to Saturday 9:00am – 5:30pm

Sunday 10:00am – 4:00pm

***Stores vary. Majors and Restaurants generally trade additional hours.**

Leasing Opportunity

With over 85 retail spaces, Q Super Centre is always on the lookout for quality new tenants to add to our retail mix. We would be happy to discuss the current opportunities with you to see what we have that can best suit your individual requirements.



WHAT A FIND!

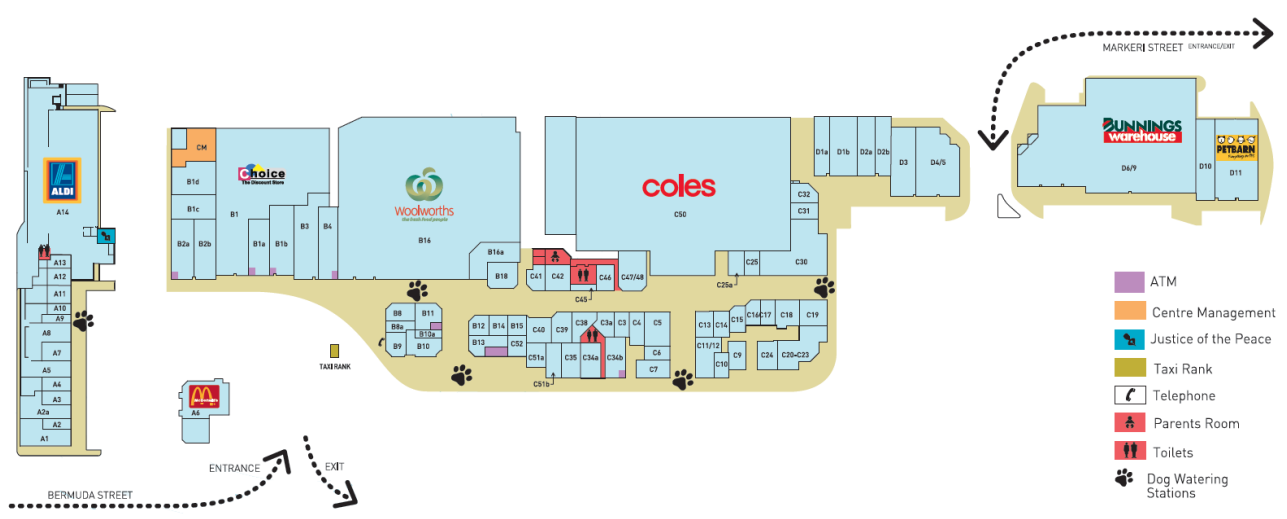

For further details, please contact

Simeon Clerke
Centre Manager

